

one Door
endless
designs



Insulated Timber Doors 58mm & 68mm



Achieve a low U-Value with a high performance timber door.

Extra stiles & rails to allow you to cut your door to size.

Security inlay. (Secured By Design)

A cost effective way to produce a quality exterior door.

One Door Endless Designs.



O.H. Industri A/S
Smedevej 17
7430 Ikast
Denmark

T: +45 9725 1200
sales@oh-industri.dk
www.oh-industri.com

Specification	Thickness mm	U-Value W/m ² K*	Core material	Weight kg/m ²	Dimension mm	Cut down to mm
Veneer for paint	58	0,89	Polystyrene	23,5	935 x 2150 1155 x 2400	715 x 1750 935 x 2000
	68	0,70	Polystyrene	25,9	935 x 2150 1155 x 2400	715 x 1750 935 x 2000

Veneer for paint

Sliced front ChenChen veneer for paint with a 6mm cross banded veneer construction and a 0,3 mm aluminum layer.

*Calculated as center U-Value.

Front view

Indicates position of steel nails in corners

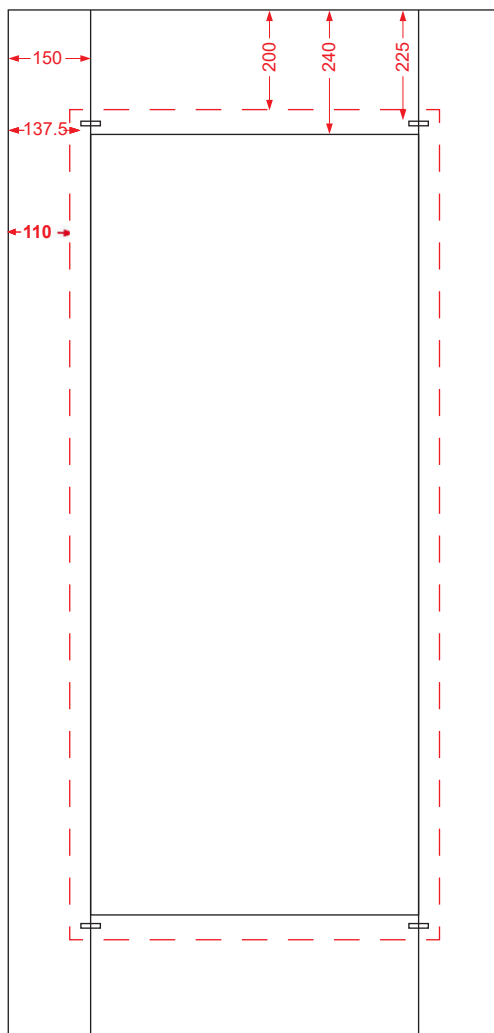

Door U-Value after trimming

Trimmed to 55mm stiles/rails

Trimmed to 110mm stiles/rails

Thickness mm	U-Value W/m ² K	Thickness mm	U-Value W/m ² K
58	1,09	58	1,25
68	0,87	68	1,03

Section view

Stiles 150 mm (Rails top/bottom 240 mm) pine wood

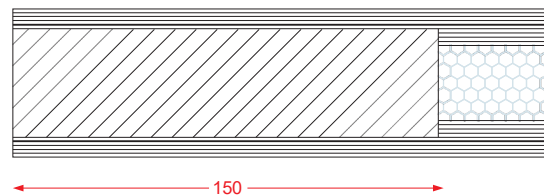

Standard Guidelines

- All cutouts for letter boxes, glazing, spyholes etc. should be fully sealed to prevent water ingress.
- Protect all cutouts with aluminium tape to prevent any moisture from entering the core of the door.
- Maximum depth for grooves on veneer is 3mm.
- Always follow the recommended coating system of your paint supplier.
- For a copy of our full Guidelines for door blanks, please speak to your stockist or visit www.oh-industri.com

Fitting / Assembly Instruction

one Door
endless
designs



1

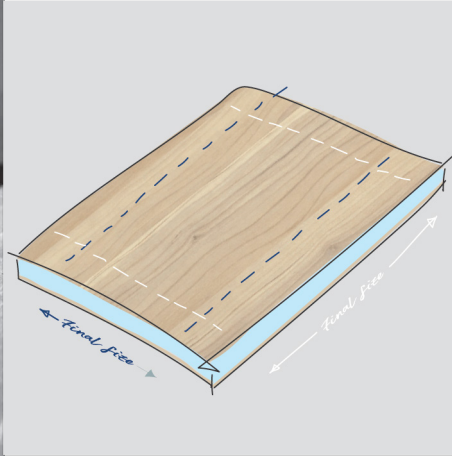

Cut to size

Each door blank can be cut to size to suit your requirements. Please see size options below and product data on the back page for more details.

Stock Size width x height

935 x 2150 mm

1155 x 2400 mm

Cut down to width x height

715 x 1750 mm

935 x 2000 mm



2

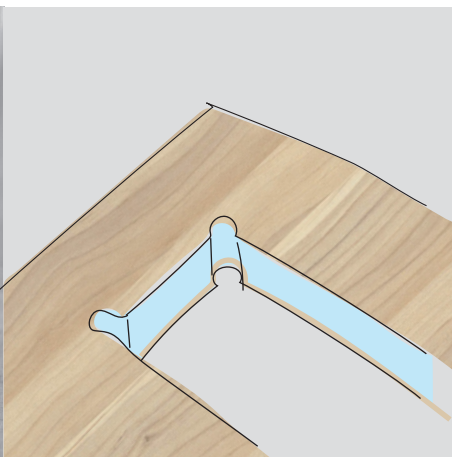

Cut-outs

Prepare all cutouts for glazings, hinges, spyholes letterboxes etc. using standard tools.

Should you require detailed information please refer to the OH Industri website.



3



4

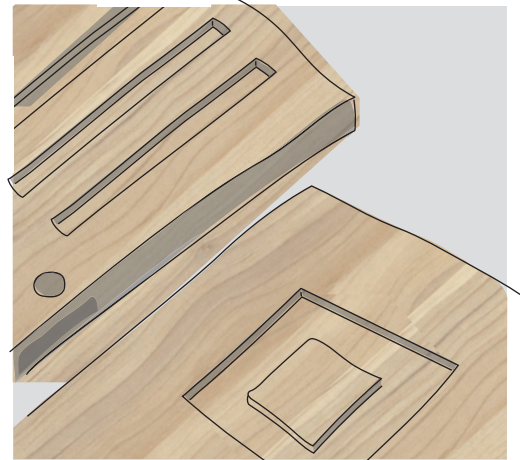

Grooves and rebating

The veneer surface can be grooved to a maximum depth of 3 mm to create the desired design by using conventional tooling.

Rebating and fitting of bolection moulds

If you are using a bolection mould, rebate the surface of the door to a maximum of 3 mm to receive the finished cassette as per diagram. Pin and glue to surface ensuring that you seal the edges.

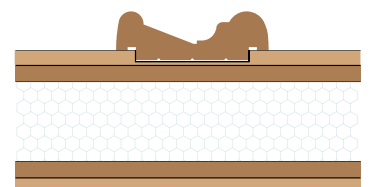

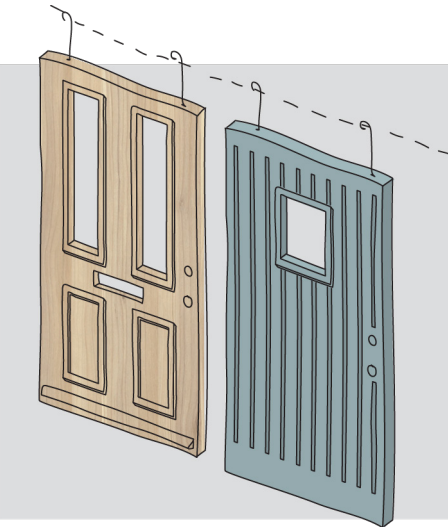

Prime / Paint

There are no additional processes required when priming and painting OH Door Blanks. Simply follow the specification and recommendations from your paint supplier.



Fit hardware and glazing

Once the top coat is dry and ready to glaze, simply fit all required hardware as per your normal method and glaze the door if required.

Please refer to the OH Industri website to ensure the correct sealing and fitting guidelines are followed.



A door finished to your style

The OH Industri door blank gives you the flexibility to produce endless designs to suit your customer requirements.

Low U-Values and a quality external entrance door without the complexity of a traditional frame door.

Please contact OH Industri or speak to your stockist should you require additional information.