

## Door blank with Oak veneer / 110 mm stiles and rails / 4 mm SBD

**Facing:** 1,5 mm Oak veneer on cross banded plywood with 0,3 mm aluminium  
**Stiles:** 110 mm finger joint oak timber  
**Rails:** 110 mm finger joint oak timber  
**Core:** Polystyrene insulation + 2x4 mm plywood SBD

U-Value - W/m²K									
54 mm	60 mm	68 mm							
1,17	1,08	0,97							

Heat conductivity is calculated on the basis of the practical heat conductivity of each included material - taken from data sheets and DS418:2011

Weight appr. Kg./m²									
54 mm	60 mm	68 mm							
20,8	22,1	23,8							

Size 1000 x 2000 mm.

Performance:	Classification standards	Performance
Operating Forces	EN12217	Class 5
Climatic Influences	EN12219	Class 3
Security	EN1627 / EN1628-30	N/A
Sound	EN10140-2	22 dB
Fire	EN13501-2 / EN1634-1	N/A
FSC Certified	FSC-STD-40-004 V2-1/FSC-STD-50-001 V1-2	N/A

General tests has been carried out on a 68 mm. door blank with chen-chen veneer.  
 Sound tests has been carried out on a 60 mm. door blank with chen-chen veneer.  
 Size 1000 x 2100 mm. Stiles and rails 55 mm.

**Measure:** Min.: 250 x 450 mm - Max.: 1200 x 2400 mm

**Tolerances:**  
 Door blank: Width/Height: +/- 1 mm - Diagonal: +/- 2 mm - Thickness: +/- 0,8 mm  
 Facing: Measurements on facing is before final sanding  
 Stiles and rails: Width: +/- 2 mm  
 Core: Inserts: +/- 1 mm on plywood

### Elevation and section drawing:

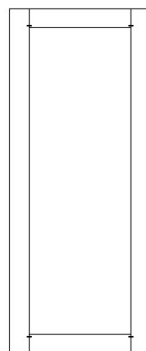

Stiles and rails: Front perspective

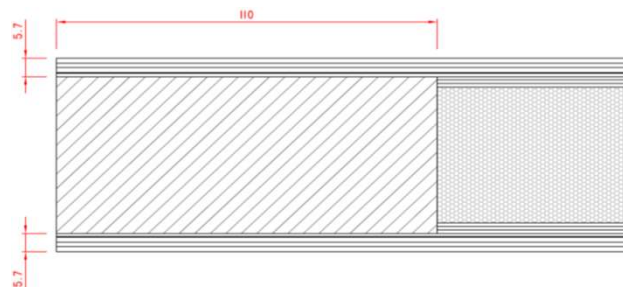

Made: 28.06.2021	Data sheet: CRS	Draw.: CRS
Revised: 01.12.2021	Data sheet: CRS	Draw.: CRS