

Door blank with Chen-Chen veneer - 55 mm stiles and rails - SBD 9

Construction:

- 1,5 mm Chen-Chen veneer
- 1,5 mm cross grain veneer
- 1,5 mm long grain veneer
- 0,3 mm Aluminium - moisture barrier - stabilizer
- 1,5 mm long grain inner veneer
- Insulation - Fibre board/2 x 9 mm plywood
- 1,5 mm long grain inner veneer
- 0,3 mm Aluminium - moisture barrier - stabilizer
- 1,5 mm long grain veneer
- 1,5 mm cross grain veneer
- 1,5 mm Chen-Chen veneer

U-Value:

Thickness (mm)

U-Value

U-Value - W/m ² K								
44 mm	54 mm	58 mm	60 mm	68 mm	73 mm	80 mm	88 mm	
1,50	1,45	1,44	1,18	1,05	0,97	0,91	0,89	

Size 1000 mm x 2000 mm

Heat conductivity is calculated on the basis of the practical heat conductivity of each included material - taken from data sheets and DS418, version 6, 2002. Also relating to EN 12524.

Weight:

Thickness (mm)

Weight

Weight appr. Kg./m ²								
44 mm	54 mm	58 mm	60 mm	68 mm	73 mm	80 mm	88 mm	
21,3	24,3	25,5	26,1	28,5	30,0	32,1	34,6	

Size 1000 mm x 2000 mm

Measure:

Min.: 250 x 450 mm - Max.: 1200 x 2400 mm

Tolerances:

Width/Height: +/- 1 mm - Diagonal: +/- 2 mm - Thickness: +/- 0,8 mm

Section drawing:

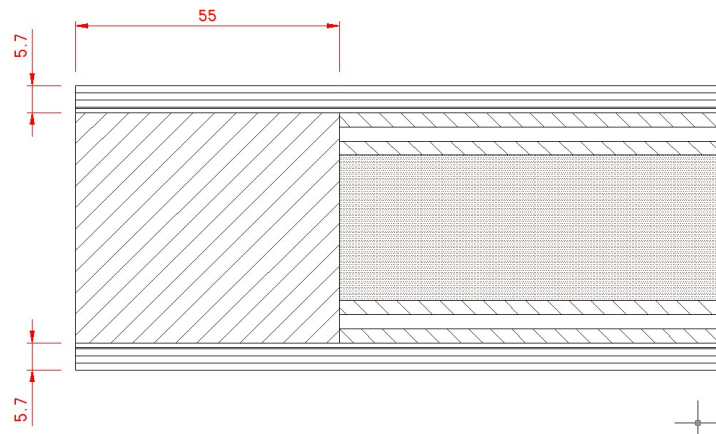

Made: 16.11.2016	Data sheet: CRS	Draw.: CRS
Revised:	Data sheet:	Draw.:

O.H.Industri A/S
 Smedevej 17
 DK - 7430 Ikast
 +45 9725 1200
www.ohindustri.com